

MAZZUCATO  
NEVER BORING



www.mazzucato-world.com

follow us on  

#### How the Reverse Industrial Movement works

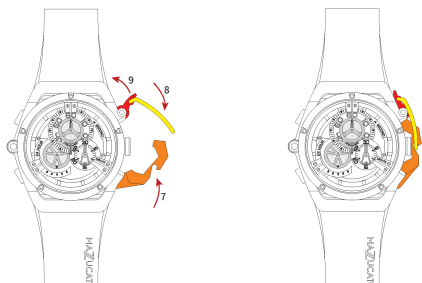

- 7 Close the protection arm
- 8 Close the wire clasp
- 9 Lock the hook

#### 3 Hands Automatic Caliber MIYOTA 9015

##### To set the time

Pull crown gently to position 2.  
Turn crown to set the hands to desired time.  
Push crown back to position 0.

##### To make full-winded

The watch can be wound by turning the crown 40 times and by wrist movement it maintains the charge. When it's not worn the charge will last for maximum 48 hours.

\*N/A

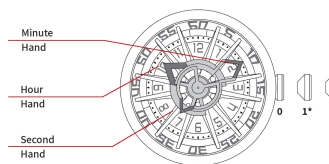

#### Chronograph Quartz Caliber MIYOTA JS00

##### To start and stop the chronograph

Push B.

##### To reset the chronograph

Push A.  
(This will reset Chronograph 60 seconds and Chronograph 30 minutes.

The unit (gate) time of measurement must be set at "10 sec." And the measurement must be performed in the form of complete watch.

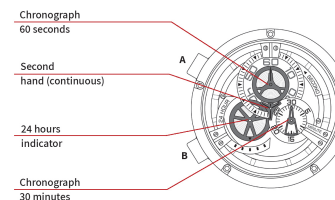

RIM

#### INSTRUCTIONS MANUAL



RIM

INSTRUCTIONS  
MANUAL

## INDEX

- 4 RIM: components
- 6 How the Reverse Industrial Movement works
- 12 3 Hands Automatic Caliber MIYOTA 9015
- 14 Chronograph Quartz Caliber MIYOTA JS00

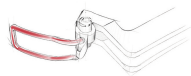

## RIM: components

- 1 Upper frame and strap
- 2 Hook
- 3 Wire clasp
- 4 Case body
- 5 Protection arm
- 6 Lower frame and strap



## How the Reverse Industrial Movement works



- 1 Unlock the hook



- 2 Open the wire clasp
- 3 Open the protection arm

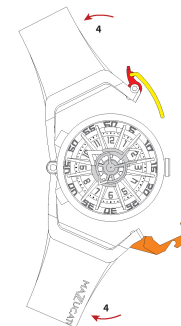

- 4 Open the upper and lower frames



- 5 Rotate the case body 180 degrees
- 6 Open the upper and lower frames